

# Midea Owner's Manual

## Remote Control

### RG10L5(2HS)

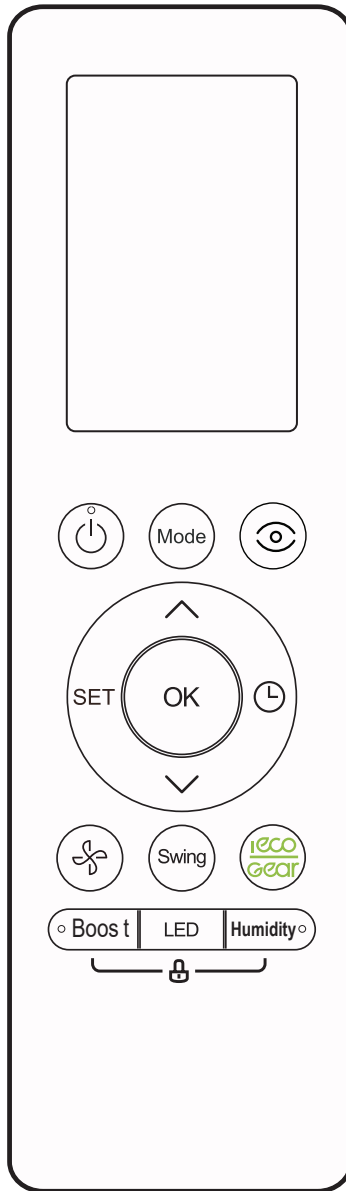

Warning notices: Before using this product, please read this manual carefully and keep it for future reference. The design and specifications are subject to change without prior notice for product improvement. Consult with your dealer or manufacturer for details. The diagram above is just for reference. Please take the appearance of the actual product as the standard.

# Thank You

Thank you for choosing Midea! Before using your new Midea product, please read this manual thoroughly to ensure that you know how to operate the features and functions that your new appliance offers in a safe way.

## Table of Contents

<b>Specifications</b> .....	<b>3</b>
<b>Quick Start Guide</b> .....	<b>3</b>
<b>Handling The Remote Control</b> .....	<b>4</b>
<b>Buttons &amp; Functions</b> .....	<b>5</b>
<b>Remote Screen Icon</b> .....	<b>6</b>
<b>How To Use Basic Functions</b> .....	<b>7</b>
Basic Operation.....	7
Setting The Timer.....	9
<b>How To Use Advanced Functions</b> .....	<b>10</b>

# Specifications

Model	RG10L5(2HS)/BGEFU1
Rated Voltage	3.0 V ( Dry batteries R03/LR03×2)
Signal Receiving Range	8 m
Environment	23°F~140°F (-5°C~60°C)

## Quick Start Guide

### 1 INSERT BATTERIES

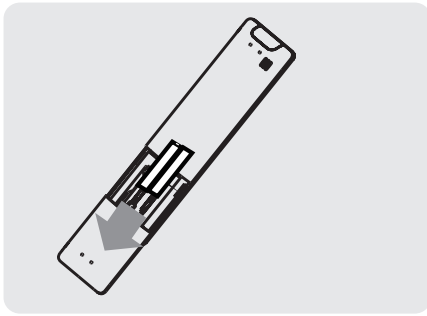

### 2 SELECT MODE

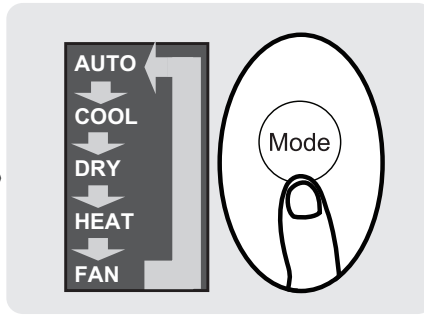

### 3 SELECT TEMPERATURE

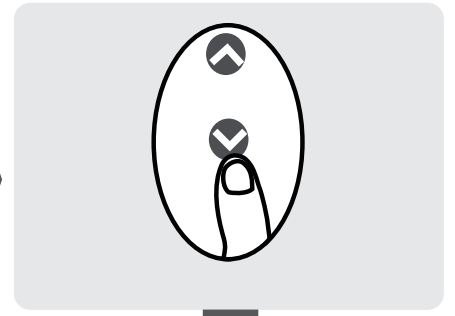

### 6 PRESS POWER BUTTON

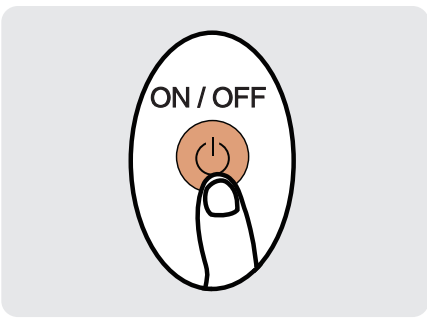

### 5 POINT REMOTE TOWARD UNIT

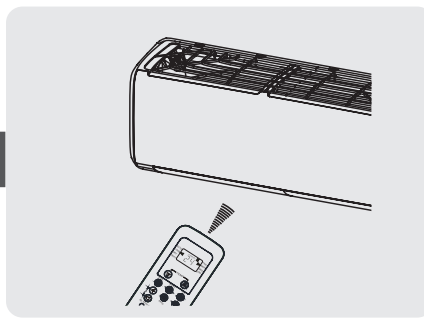

### 4 SELECT FAN SPEED



## NOT SURE WHAT A FUNCTION DOES?

Refer to the **How to Use Basic Functions** and **How to Use Advanced Functions** sections of this manual for a detailed description of how to use your air conditioner.

### SPECIAL NOTE

- Button designs on your unit may differ slightly from the example shown.
- If the indoor unit does not have a particular function, pressing that function's button on the remote control will have no effect.
- When there are wide differences between "Remote controller Manual" and "USER'S MANUAL" on function description, the description of "USER'S MANUAL" shall prevail.

# Handling The Remote Control

## Inserting and Replacing Batteries

Your air conditioning unit may come with two batteries (some units). Put the batteries in the remote control before use.

1. Slide the back cover from the remote control downward, exposing the battery compartment.
2. Insert the batteries, paying attention to match up the (+) and (-) ends of the batteries with the symbols inside the battery compartment.
3. Slide the battery cover back into place.

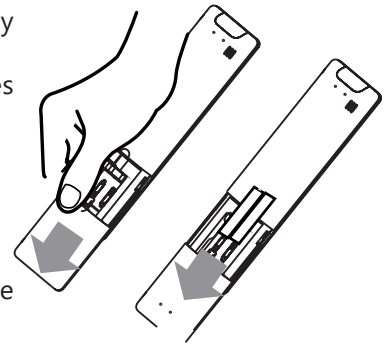

## ⚠ Remote Control Cautions

- Direct sunlight can interfere with the infrared signal receiver.
- There must be a clear line of sight between the remote and the appliance.
- If the signals from the remote control happen to control another appliance, move the appliance to another location, or contact customer service.

## Battery Disposal

- Do not dispose of batteries as unsorted municipal waste. Refer to local laws for proper disposal of batteries.
- Batteries may have a chemical symbol at the bottom of the disposal icon. This chemical symbol means that the battery contains a heavy metal that exceeds a certain concentration. An example is Pb: Lead (>0.004%).
- Appliances and used batteries must be treated in a specialized facility for reuse, recycling, and recovery. By ensuring correct disposal, you will help avoid possible negative consequences for the environment and human health.



## Battery Performance

For optimal product performance:

- Do not mix old and new batteries, or batteries of different brands.
- Do not leave batteries in the remote control if you don't plan on using the device for more than 2 months.

## Notes For Using The Remote Control

The device complies with the local national regulations.

- In Canada, it should comply with CAN ICES-3(B)/NMB-3(B).
- In the USA, this device complies with part 15 of the FCC Rules. Operation is subject to the following two conditions:
  1. This device may not cause harmful interference, and
  2. This device must accept any interference received, including interference that may cause undesired operation.

This equipment has been tested and found to comply with the limits for a Class B digital device, pursuant to part 15 of the FCC Rules. These limits are designed to provide reasonable protection against harmful interference in a residential installation. This equipment generates, uses, and can radiate radio frequency energy and, if not installed and used following the instructions, may cause harmful interference to radio communications. However, there is no guarantee that interference will not occur in a particular installation. If this equipment does cause harmful interference to radio or television reception, which can be determined by turning the equipment off and on, the user is encouraged to try to correct the interference by one or more of the following measures:

- Reorient or relocate the receiving antenna.
- Increase the separation between the equipment and receiver.
- Connect the equipment to an outlet on a circuit different from that to which the receiver is connected.
- Consult the dealer or an experienced radio/TV technician for help.

Changes or modifications not approved by the party responsible for compliance could void the user's authority to operate the equipment.

# Buttons & Functions

Before you begin using your new air conditioner, make sure to familiarize yourself with its remote control. The following is a brief introduction to the remote control itself. For instructions on how to operate your air conditioner, refer to the How to Use Basic Functions section of this manual.

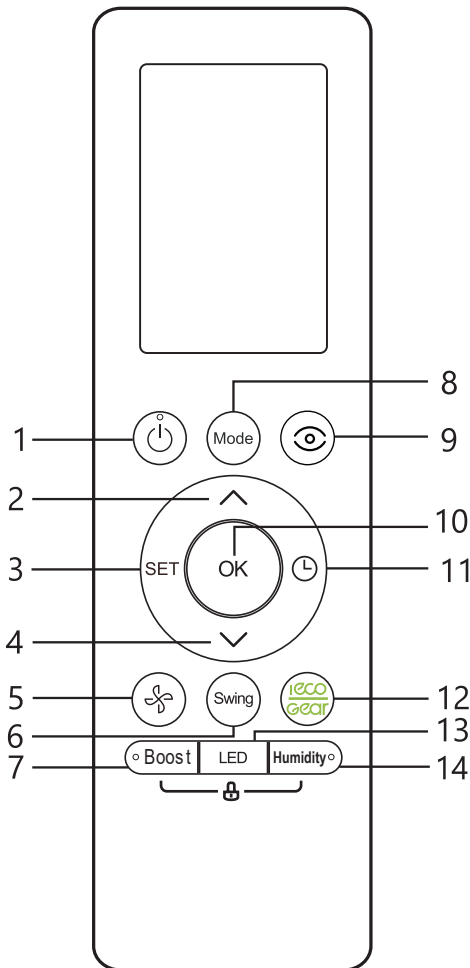

Callout No.	Button Image	Description
1		<b>ON/OFF</b> Turns the unit on or off.
2		<b>TEMP</b> Increases temperature in 1°F (0.5°C) increments. Max. temperature is 86°F (30°C). <b>NOTE:</b> Press together ∨ & ^ buttons at the same time for 3 seconds will alternate the temperature display between °C & °F.
3		<b>SET</b> Scrolls through operation functions as follows: Breeze away*() → Active clean () → Fresh () → Sleep() → Follow Me () → AP mode () → Active clean..... The selected symbol will flash on the display area. Press the OK button to confirm.
4		<b>TEMP</b> Decreases temperature in 1°F (0.5°C) increments. Min. temperature is 60°F (16°C).
5		<b>FAN SPEED</b> Selects fan speeds in the following order: AU 20% → 40% → 60% → 80% → 100%. Press the TEMP ^ or ∨ button to increase/decrease the fan speed in 1% increments.
6		<b>SWING</b> Starts and stops the horizontal louver movement. Hold down for 2 seconds to initiate vertical louver auto swing feature.
7		<b>BOOST</b> Enables the unit to reach the present temperature in the shortest possible time. Keep pressing this button for more than 5 seconds in heating mode to activate Super heat operation. To stop this feature, keep pressing this button for more than 3 seconds.
8		<b>MODE</b> Scrolls through operation modes as follows: AUTO→COOL→DRY→HEAT→FAN
9		<b>ECO INTELLIGENT EYE</b> Used to detect people's activities in the room to save energy.
10		<b>OK</b> Used to confirm the selected functions.
11		<b>TIMER</b> Set the timer to turn the unit on or off.
12		<b>ECO/GEAR</b> Press this button to enter the energy efficient mode in a sequence of the following: ECO → GEAR (75%) → GEAR (50%) → Previous setting mode → ECO
13		<b>LED</b> Turns the indoor unit's LED display and air conditioner buzzer on and off, which creates a comfortable and quiet environment.
14		<b>HUMIDITY</b> Adjust the room humidity during Dry operation in a range of 35%~85%. Press this button to increase the humidity in 5% increments. <b>NOTE:</b> After setting, the humidity settings will display on the screen.
[*] Only available for the unit with this feature.		

# Remote Screen Icon

Information are displayed when the remote controller is powered up.

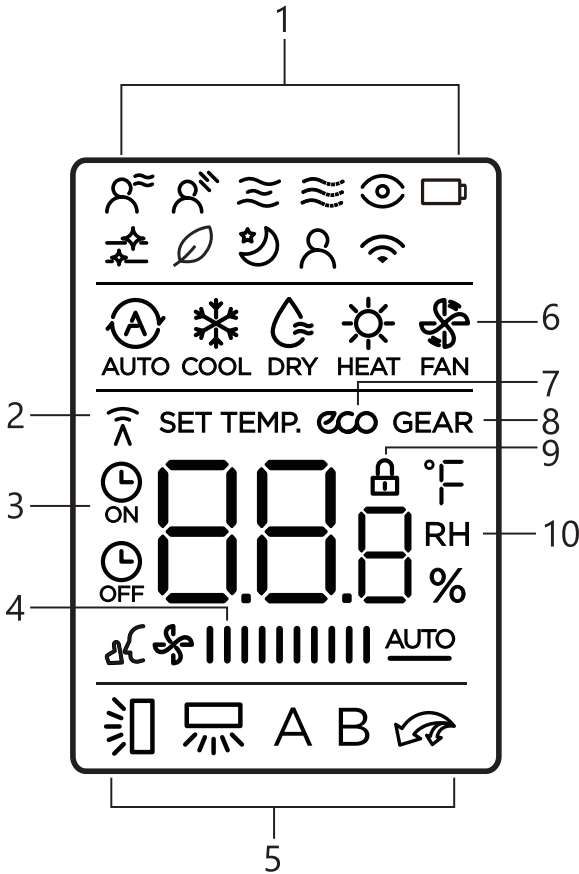

## NOTE

All indicators shown in the figure are presented to explain the meaning of each icon. But during the actual operation, only the relative function signs are shown on the display window.

Callout No.	Description
1	Not applicable for this unit
	Breeze Away display
	Not applicable for this unit
	Not applicable for this unit
	ECO intelligent eye display
	Low battery detection display (If it flashes)
	Active clean feature display
	Fresh feature display
	Sleep mode display
	Follow me feature display
Wireless control feature display	
2	<b>TRANSMISSION</b> Indicator Lights up when remote sends signal to indoor unit.
3	ON       OFF <b>SILENCE</b> feature display
4	<b>FAN SPEED</b> Display Displays selected fan speed: Silence —  1% 2%-20% LOW      21%-40% MED      41%-60% HIGH     61%-80% 81%-100% AUTO <b>AUTO</b> This fan speed cannot be adjusted in AUTO or DRY mode.
5	→  →  →  Horizontal louver swing display Vertical louver auto swing display A Not applicable for this unit. B Not applicable for this unit. Boost mode display
6	<b>MODE</b> display Displays the current mode, including: AUTO COOL DRY HEAT FAN
7	<b>ECO</b> display Displays when the <b>ECO</b> feature is activated.
8	<b>GEAR</b> display Displays when the <b>GEAR</b> feature is activated.
9	<b>LOCK</b> display Displays when the <b>LOCK</b> feature is activated.
10	Temperature/Timer/Fan speed/Humidity display Displays the set temperature by default, or fan speed, or timer setting when using the <b>TIMER ON/OFF</b> functions. • Temperature range: 60-86°F/16-30°C (/68-82°F/ 20-28°C) (Model dependent) • Timer setting range: 0-24 hours • Fan speed setting range: AU -100% • Humidity setting range: 35% -85% This display is blank when operating in <b>FAN</b> mode.

# How To Use Basic Functions

## Basic Operation

ATTENTION! Before the operation, please ensure the unit is plugged in and power is available.

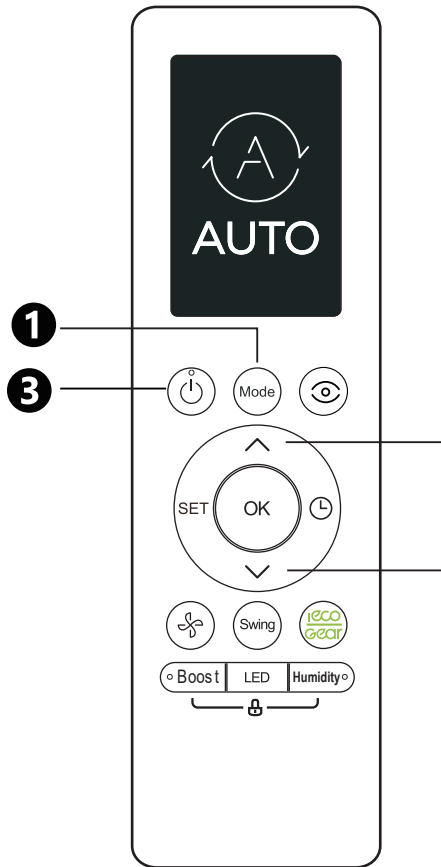

### Setting The Temperature

The operating temperature range for units is 60–86°F (16–30°C)/ 68–82°F (20–28°C) (Model-dependent). You can increase or decrease the set temperature in 1°F (0.5°C) increments.

### AUTO Mode

In AUTO mode, the unit will automatically select the COOL, FAN, or HEAT operation based on the set temperature.

- 1 Press the **MODE** button to select **AUTO**.
- 2 Set your desired temperature using the **TEMP**  $\wedge$  or **TEMP**  $\vee$  button.
- 3 Press the **ON/OFF** button to start the unit.

**NOTE**  
FAN SPEED can't be set in **AUTO** mode.

### COOL Mode

- 1 Press the **MODE** button to select **COOL** mode.
- 2 Set your desired temperature using the **TEMP**  $\wedge$  or **TEMP**  $\vee$  button.
- 3 Press **FAN** button to select the fan speed in a range of AU-100%.
- 4 Press the **ON/OFF** button to start the unit.

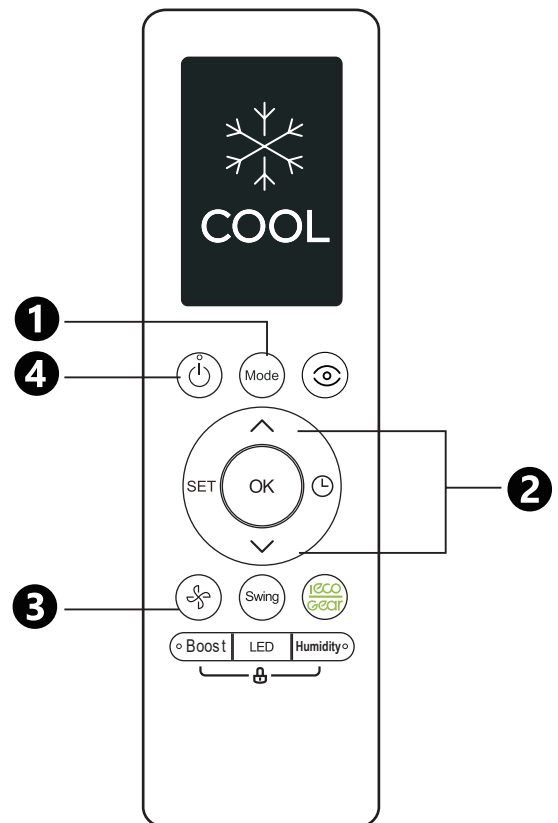

## DRY Mode (Dehumidifying)

- 1 Press the **MODE** button to select **DRY** mode.
- 2 Set your desired temperature using the **TEMP ^** or **TEMP v** button.
- 3 Press the **ON/OFF** button to start the unit.

### NOTE

**FAN SPEED** cannot be changed in **DRY** mode.

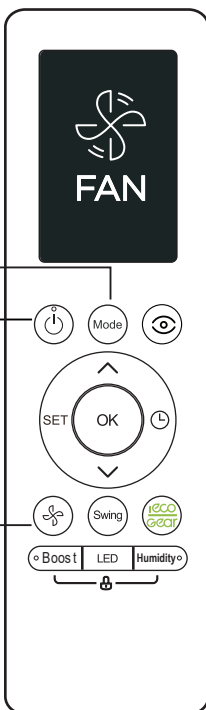
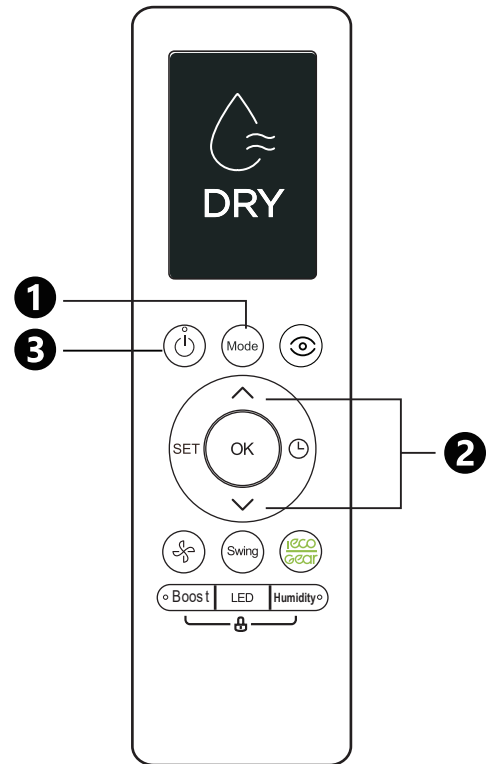

## FAN Mode

- 1 Press the **MODE** button to select **FAN** mode.
- 2 Press the **FAN** button to select the fan speed in a range of AU-100%.
- 3 Press the **ON/OFF** button to start the unit.

### NOTE

You can't set the temperature in **FAN** mode. As a result, your remote control's LCD screen will not display temperature.

## HEAT Mode

- 1 Press the **MODE** button to select **HEAT** mode.
- 2 Set your desired temperature using the **TEMP ^** or **TEMP v** button.
- 3 Press **FAN** button to select the fan speed in a range of AU-100%.
- 4 Press the **ON/OFF** button to start the unit.

### NOTE

As outdoor temperature drops, the performance of your unit's **HEAT** function may be affected. In such instances, we recommend using this air conditioner in conjunction with other heating appliances.

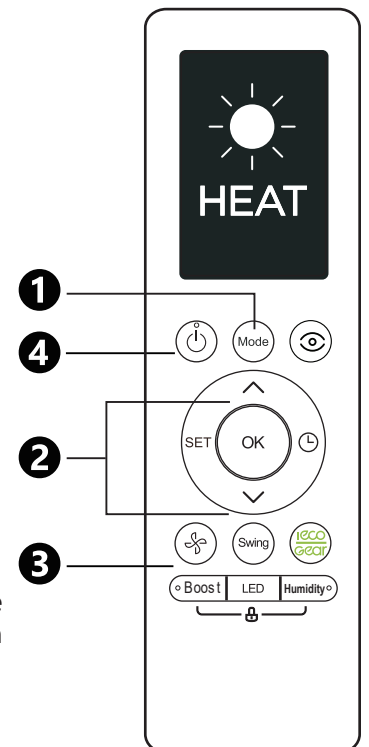

# Setting The Timer

**TIMER ON/OFF** - Set the amount of time after which the unit will automatically turn on/off.

## Timer On Setting

Press the **TIMER** button to initiate the **ON** time sequence.

Press Temp. up or down button multiple times to set the desired time to turn on the unit.

Point the remote at the unit and wait for 1 second, the **TIMER ON** will be activated.

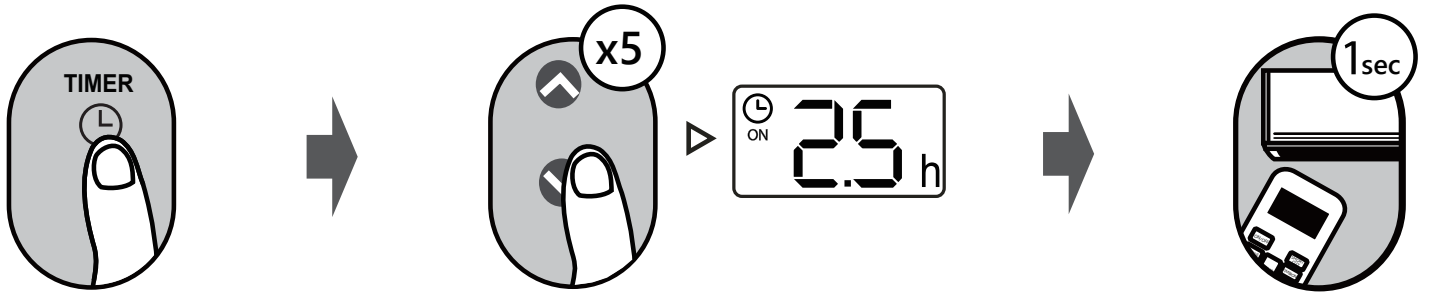

## TIMER OFF setting

Press the **TIMER** button to initiate the **OFF** time sequence.

Press Temp. up or down button multiple times to set the desired time to turn off the unit.

Point the remote at the unit and wait 1 second, the **TIMER OFF** will be activated.

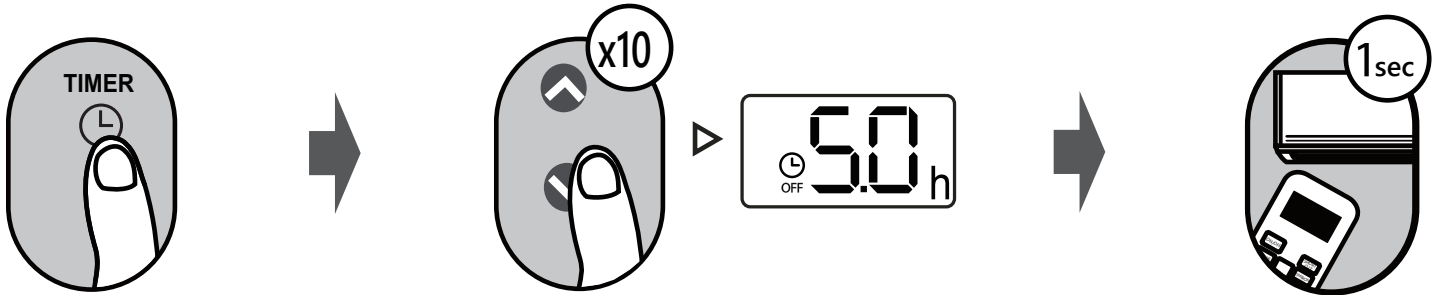

## NOTE

1. When setting the **TIMER ON** or **TIMER OFF**, the time will increase by 30-minute increments with each press, up to 10 hours. After 10 hours and up to 24, it will increase in 1-hour increments. (For example, press 5 times to get 2.5h, and press 10 times to get 5h). The timer will revert to 0.0 after 24.
2. Cancel either function by setting its timer to 0.0h.

## Timer On & Off Setting (Example)

Keep in mind that the periods you set for both functions refer to hours after the current time.

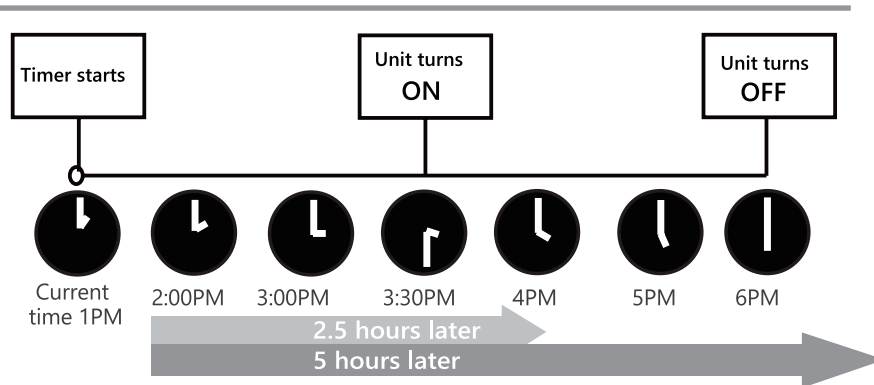
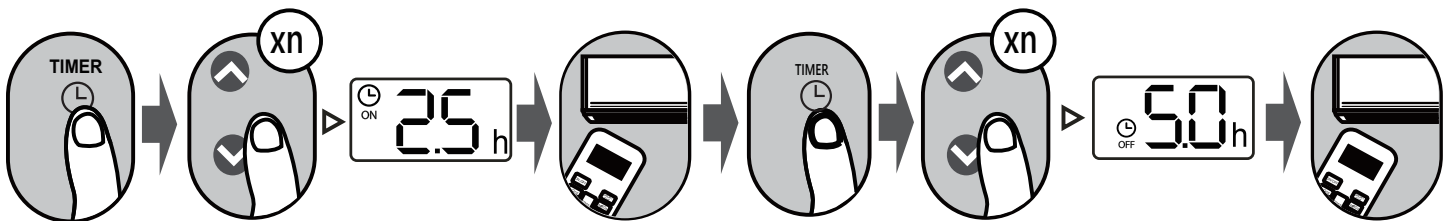

Example: If the current timer is 1:00 PM, to set the timer as above, the unit will turn on 2.5 hours later (3:30 PM) and turn off at 6:00 PM.

# How To Use Advanced Functions

## Swing Function

Press the Swing button

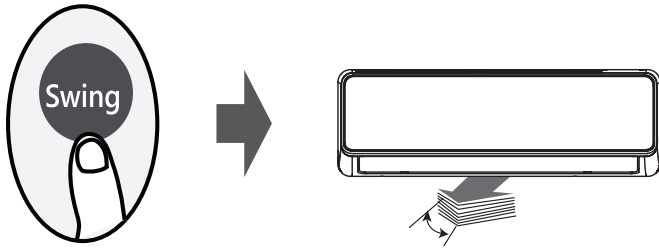

The horizontal louver will swing up and down automatically when pressing the Swing button.

Press again to make it stop.

## Airflow Direction

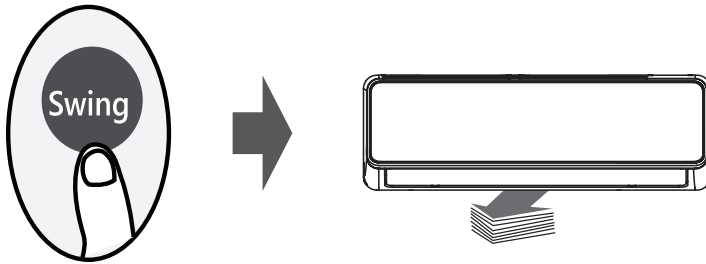

## NOTE

When the unit is off, press and hold the MODE and SWING buttons together for one second; the louver will open to a certain angle, which makes it very convenient for cleaning. Press and hold the MODE and SWING buttons together for one second to reset the louver (some units only).

## LED Display

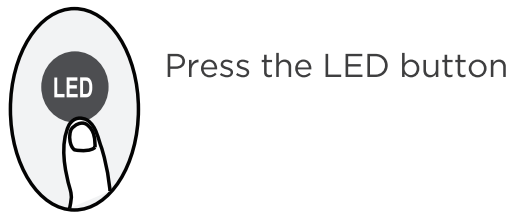

Press the LED button

Press this button to turn on and turn off the display on the indoor unit.

## ECO/GEAR Function



Press the X-ECO button to enter the energy-efficient mode in this following sequence: ECO → GEAR(75%) → GEAR(50%) → Previous setting mode → ECO.....

## NOTE

This function is only available under COOL mode.

## ECO Operation:

Under cooling mode, press this button, the remote controller will adjust the temperature automatically to 75°F/24°C, fan speed of Auto to save energy (only when the set temperature is less than 75°F/24°C). If the set temperature is above 75°F/24°C, press the ECO button; the fan speed will change to Auto, and the set temperature will remain unchanged.

## NOTE

Pressing this button, modifying the mode, or adjusting the set temperature to less than 75°F/24°C will stop ECO operation. Under ECO operation, the set temperature should be 75°F/24°C or above; it may result in insufficient cooling. If you feel uncomfortable, just press the ECO button again to stop it.

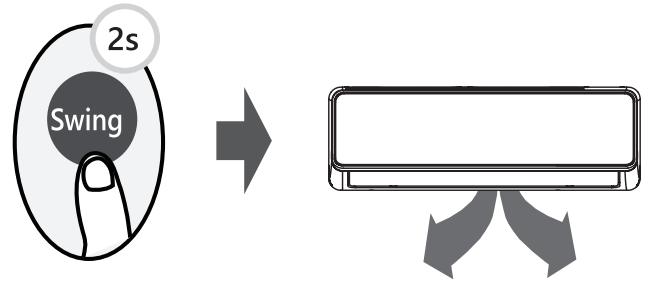

Keep pressing this button for more than 2 seconds, and the vertical louver swing function is activated. (Model dependent)

If you continue to press the SWING button, you can set five different airflow directions. The louver can be moved within a certain range each time you press the button. Press the button until the direction you prefer is reached.

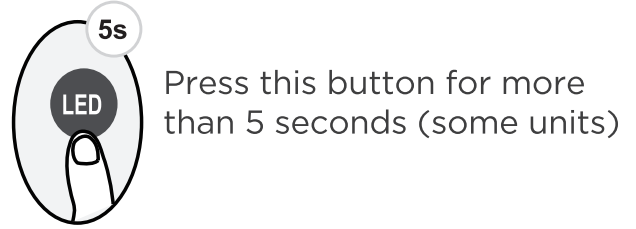

Press this button for more than 5 seconds (some units)

Keep pressing this button for more than 5 seconds, and the indoor unit will display the actual room temperature. Pressing more than 5 seconds again will revert to displaying the setting temperature.

### GEAR Operation:

Press the ECO/GEAR button to enter the GEAR operation as follows: 75% (up to 75% electrical energy consumption)



50% (up to 50% electrical energy consumption)



Previous setting mode.

Under GEAR operation, the display on the remote controller will alternate between electrical energy consumption and set temperature.

### ECO Intelligent Eye Function

Press this button



Under ECO Intelligent eye mode, with the built-in infrared sensor, the unit can detect people's activities in the room. In Cooling and Heating mode, when you are away for 30 minutes, the unit automatically lowers the frequency to save energy (for inverter models only). And the unit will automatically resume operation if sensing human activity again.

### Silence Function



Keep pressing the Fan button for more than 2 seconds to activate/disable the Silence function (some units). Due to the low frequency operation of the compressor, it may result in insufficient cooling and heating capacity. Pressing the ON/OFF, Mode, Sleep, Turbo, or Clean button while operating will cancel the silence function.

### FP Function

Press this button 2 times during one second under HEAT Mode and set the temperature to 60°F/16°C.

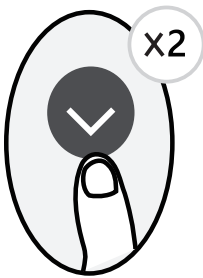

The unit will operate at a high fan speed (while the compressor is on) with the temperature automatically set to 46°F/8°C.

#### NOTE

This function is for a heat pump air conditioner only.

Press this button 2 times during one second under HEAT Mode with the setting temperature of 60°F/16°C to activate the FP function. Press On/Off, Sleep, Mode, Fan and Temp. button or select the Sleep feature while operating will cancel this function.

### LOCK Function

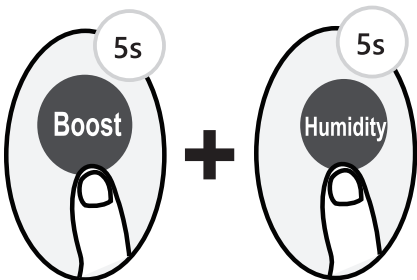

Press together the **Boost** button and the **Humidity** button at the same time, more than 5 seconds to activate the Lock function. All buttons will not respond except by pressing these two buttons for two seconds again to disable locking.

### BOOST Function

Press the Boost button



When you select the Boost feature in COOL mode, the unit will blow cool air with the strongest wind setting to jump-start the cooling process. When you select the Boost feature in HEAT mode, for units with Electric heat elements, the Electric HEATER will activate and jump-start the heating process.

## Super Heat Function

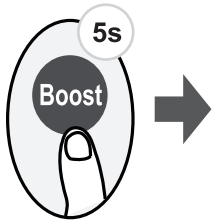

Long-press press Boost button for 5 seconds in Heating/Auto heating mode to initiate the super heat function. To stop this feature, long-press this button for 3 seconds. This function is mainly used to improve the heating speed of the unit at low temperatures.

Under super heat mode, the louver will open to its maximum angle to enable the unit to reach the preset temperature in the shortest possible time.

### NOTE

The anti-cold air feature is disabled 5 minutes after the compressor starts; it may result in low air outlet temperature. You should choose whether to enable this function according to your needs.

### NOTE

- If the Super heat function is activated, " On " displays for 3 seconds on the indoor unit display window.
- If the Super heat function is stopped, " OF " displays for 3 seconds on the indoor unit display window. Change the mode or turn the unit off to stop the superheating operation.

## SET Function

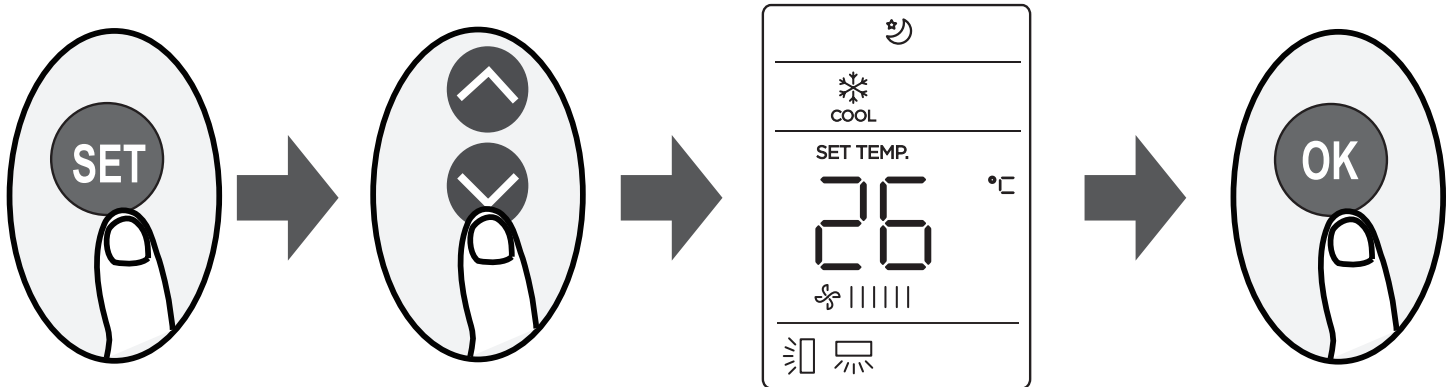

- Press the SET button to enter the function setting, then press the SET button or TEMP ▼ or TEMP ▲ button to select the desired function. The selected symbol will flash on the display area. press the OK button to confirm.
  - To cancel the selected function, just perform the same procedures as above.
  - Press the SET button to scroll through operation functions as follows: Breeze away (🌀) → Active clean (🧼) → Fresh/UV-C lamp\* (💡) → Sleep (🌙) → Follow Me (👤) → AP mode\* (📶) → Active clean (🧼)
- [ \* ]: Model dependent

## Breeze Away Function

This feature avoids direct air flow blowing on the body and makes you feel indulged in silky coolness.

### NOTE

This feature is available under cool, Fan, and Dry mode only.

## Active Clean Function (🧼)

The Active Clean Technology washes away dust, mold, and grease that may cause odors when it adheres to the heat exchanger by automatically freezing and then rapidly thawing the frost. When this function is turned on, the indoor unit display window appears "CL". After 20 to 45 minutes, the unit will turn off automatically and cancel the CLEAN function.

## FRESH/UV-C Lamp Function (💡) (some units)

When this function is selected, the ionizer or UV-C lamp (model dependent) will be activated. If it has both features, these two features will be activated at the same time. This function will help to purify the air in the room.

## Sleep Function (🌙)

The SLEEP function is used to decrease energy use while you sleep (and don't need the same temperature settings to stay comfortable). This function can only be activated via remote control.

### NOTE

The SLEEP function is not available in FAN or DRY mode.

### **Follow Me Function ( )**

The FOLLOW ME function enables the remote control to measure the temperature at its current location and send this signal to the air conditioner every 3-minute interval. When using AUTO, COOL, or HEAT modes, measuring ambient temperature from the remote control (instead of from the indoor unit itself) will enable the air conditioner to optimize the temperature around you and ensure maximum comfort.

#### **NOTE**

Press and hold the Boost button for seven seconds to start/stop the memory feature of the Follow Me function.

- If the memory feature is activated, "On" displays for 3 seconds on the screen.
- If the memory feature is stopped, "OF" displays for 3 seconds on the screen.
- While the memory feature is activated, press the ON/OFF button, shift the mode, or power failure will not cancel the Follow Me function.

### **AP Function ( ) (some units)**

Choose AP mode to configure the wireless network. For some units, it doesn't work by pressing the SET button. To enter the AP mode, continuously press the LED button seven times in 10 seconds.



## United States



<https://www.mideacomfort.us/registration.html>

## Canada

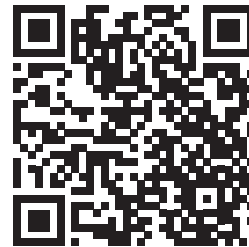

<https://www.mideacomfortna.ca/registration.html>